

## PK35F-GUIDE - Angle Iron Lateral Side Guide Roll Support Set

Maximum Angle Iron Capacity - 50 x 50 x 6mm  
 Suits PK-35F Section Rolling Machine

<b>Ex GST</b>	<b>Inc GST</b>
<b>\$1,540.00</b>	<b>\$1,694.00</b>

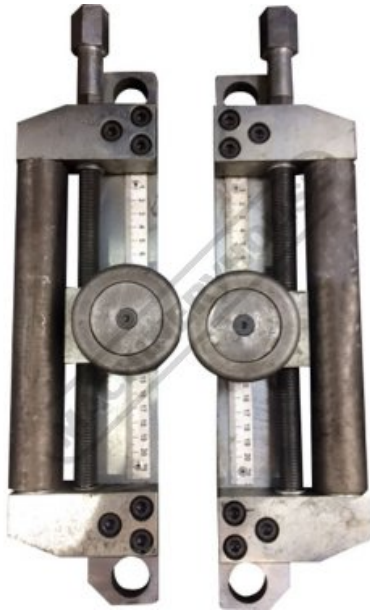

ORDER CODE:	S7455
MODEL:	PK35F-GUIDE
Rolls (Type):	~
Tube Roll Size Metric / Imperial - (OD) (mm / Inch):	~
Pipe Roll Size Metric / Imperial - (NB) (Inch / mm):	~
Bore Size (mm):	~
Suits Rolling Machines:	PK-35F



### Description

These optional guides roll supports (left & right) are used on the PK-35F section rolling machine for when you need to roll angle iron leg inwards or leg outwards

### Features

- Maximum Angle Iron Capacity - 50 x 50 x 6mm
- Please Note:
- PK-35F Section Rolling Machine will also require optional Angle Roll Dies to work in conjunction with these lateral side guide roll supports

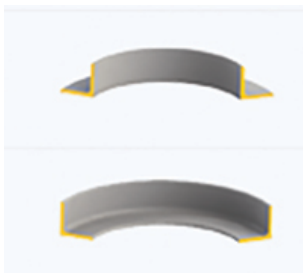

### Specific Features



Shown On Machine

### Recommended Accessories

S745  
Section & Pipe Rolling Machine

S745H  
Angle Iron Roll Dies

S741H  
Angle Iron Roll Dies

